

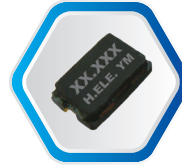

HSX530GK SERIES

GLASS SEALING PACKAGE

- ✓ RoHS Compliant
- ✓ AEC Qualified



STANDARD SPECIFICATION

| Items | Parameter | | |
|-------------------------------|-------------------|-----------|-----------|
| | 8~10 MHz | 10~40 MHz | 40~54 MHz |
| Frequency Range | 8~10 MHz | 10~40 MHz | 40~54 MHz |
| Mode | Fundamental | | |
| Frequency Tolerance (at.25°C) | ±10ppm | | |
| Load Capacitance | 6pF Min. | | |
| Drive Level | 10µW (300µW Max.) | | |
| Equivalent Series Resistance | 100Ω Max. | 80Ω Max. | 50Ω Max. |
| Storage Temp. Range | -55 ~ +125°C | | |

FREQUENCY STABILITY OVER OPERATING TEMPERATURE RANGE

| Operating Temperature | Stability |
|-----------------------|-----------|
| -40 ~ +105°C | ±20 ppm |
| -40 ~ +125°C | ±50 ppm |

*For other specification, please contact us.

Packing Unit : 1,000pcs/Reel.

DIMENSION

Unit:mm

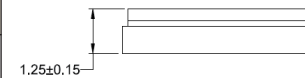
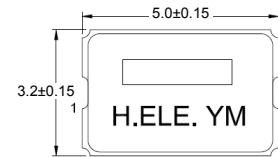

Bottom View

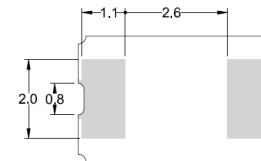

| Pin Connections | |
|-----------------|---------|
| #1 | Crystal |
| #2 | Crystal |

Internal Connection (Top View)

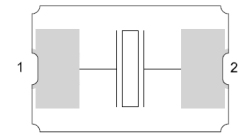

Recommended Land Pattern
Tolerance: ±0.15

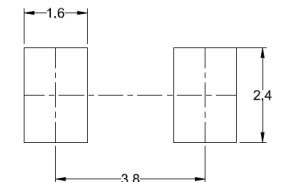

Actual Size